

SCOTTY OPERATING INSTRUCTIONS

MORPHY-RICHARDS GAS/ELECTRIC REFRIGERATOR

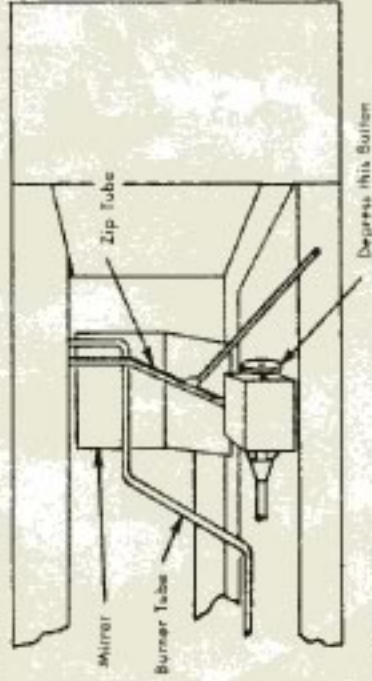

STARTING

To start the refrigerator using electricity: Remove the bottom panel, turn the left-hand knob marked "Gas" to OFF and the right-hand knob marked "Elec." to ON. Replace the bottom panel, plug into the socket and switch on the electric supply. The electric thermostatic control is located on the upper rear wall of the interior liner, set its control knob to position "C."

To start the refrigerator using bottled gas: Remove the bottom panel, turn the right-hand knob marked "Elec." to OFF and the left-hand knob marked "Gas" to ON. The gas thermostatic control is located adjacent to the ON-OFF switches, set its control knob to position "C."

Depress button on button valve and ignite gas in zip tube. Keep button depressed so that the flame from the end of the zip tube plays on the burner. The safety valve will be heard to click open and this may take up to 1½ minutes. By watching in the mirror situated below the burner at the rear of the refrigerator it can be seen whether or not the burner is lit, after which the button can be released. Once lit the heat from the burner flame will keep the safety valve in the open position and the flame will stay in. The safety valve will close again if for any reason the burner flame goes out.

It is normal when starting for the first time, or restarting after a period out of use, for the refrigerator to take some hours to reduce the temperature. It is best, therefore, to leave the control knob at setting "C" for about six hours before reducing it to setting "3."

SCOTTY OPERATING INSTRUCTIONS

MORPHY-RICHARDS GAS/ELECTRIC REFRIGERATOR

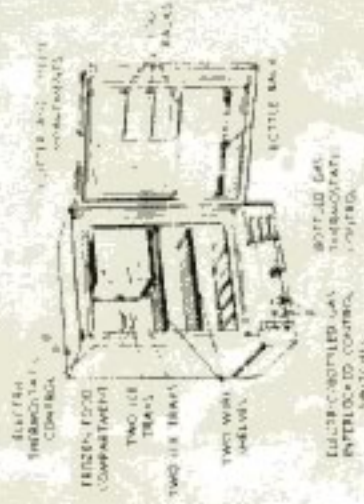

DEFROSTING

Defrosting at regular intervals results in more efficient refrigeration. The refrigerator requires defrosting when the frost coating makes the removal of the ice tray difficult. It should be carried out as follows:

- Open the door and turn control knob to position "O" or "D" depending on supply being used. Leave the door open.
- Empty the refrigerator and leave the drip tray below the evaporator.
- When the frost has melted off the evaporator the drip tray should be emptied.
- Dry the interior of the refrigerator with a clean soft cloth.
- Replace the trays, shelves and food.
- Restart the refrigerator by turning the knob to position "C" for a few hours, then reset knob to its normal position.
- DO NOT** use a fire or any other source of heat to assist defrosting or drying.
- If, when defrosting your refrigerator, you are storing frozen food, the following precautions should be taken. The packets of frozen food should be wrapped in several thicknesses of newspaper and returned to the evaporator as soon after defrosting as possible. Any undue rise in temperature of the frozen food packs during defrosting could result in a serious deterioration in flavour and texture.